

THE MASTERPLAN DESIGN APPROACH IS THE ARRANGEMENT OF INDEPENDENT DISTRICTS IN ORGANIC CLUSTERS WHICH PROMOTES SOCIALISING ON ALL LEVELS AND FOSTERS A SENSE OF LOCAL IDENTITY.

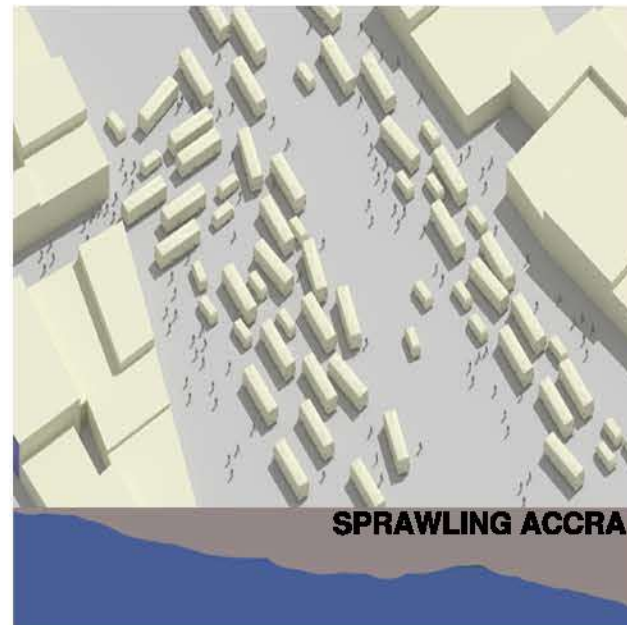

ACCRA'S RAPID DEVELOPMENT TOWARDS SMALLER FARMING COMMUNITIES THREATENS THE LIVELIHOOD OF THE PERI-URBAN AREAS. SPRAWLING MEGA-CITIES PROMOTE LESS HUMANE SPACES WHILE TRADITIONAL VILLAGES PROVIDE COMMUNITY AND INTERACTION AT A HUMAN SCALE

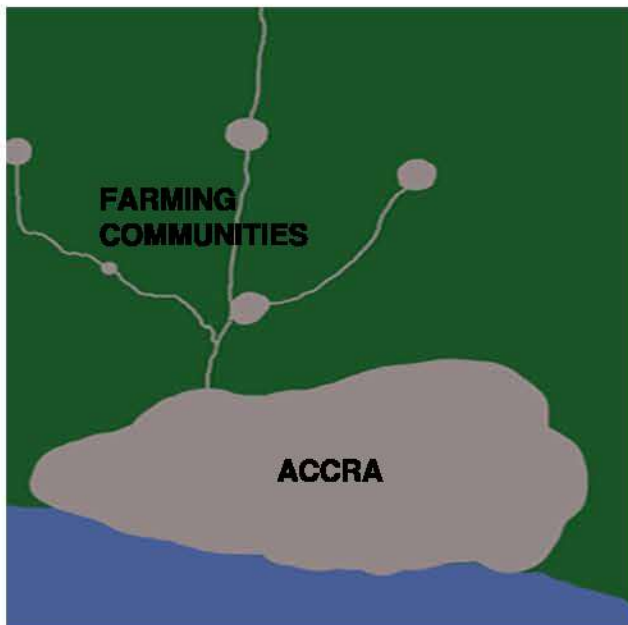
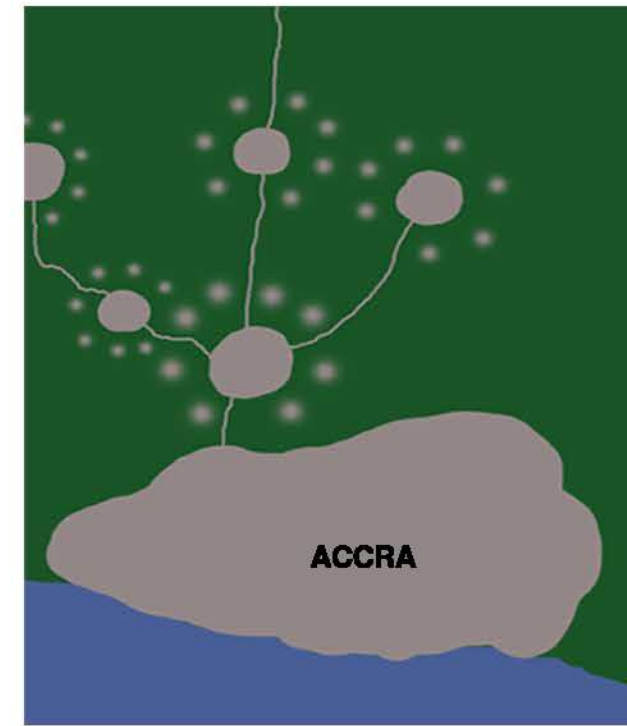

EMERGING TOWN DEVELOPMENT PATTERN SUSTAINED BY CLUSTERS OF INDEPENDENT DISTRICTS ANCHORED BY VIBRANT TOWN CENTERS



FLEXIBLE RADIAL AXIS-PLANNING MODEL INSPIRED BY AFRICAN VILLAGE CLUSTER CONCEPT.

Suhum Kroboa Coaltar District is part of 138 districts in the Eastern province of Ghana, West Africa. Agriculture is the predominant economic activity and employs about 70% of the population. Other economic sectors in the district include technical and related works, transport, sales and service.

The lack of environmental regulation and land use planning initiatives in Suhum has spurred irresponsible developments which has created unchecked sprawl in the past 20 years. Also, because of its proximity to the mega-urban center of Accra, a large percentage of the young population have migrated there fueling Accra's rapid urbanization trend. The current scenario favors neither Suhum nor Accra from a long term sustainable urban development point of view.

I see this multi-faceted dilemma as a design opportunity. My aim, therefore, is to introduce a new town planning concept that addresses the inherent problems of the existing town, putting in its place, a new model of sustainable development that will serve as a guiding principle for the town's growth.

SMART-GROWTH PLANNING MODEL

SEFAKO GBOMITA

COMMUNITY CENTER



A PLACE FOR CIVIC ENGAGEMENT

MULTI-PURPOSE CULTURAL CENTER FACILITY



A SOURCE FOR LOCAL IDENTITY THROUGH CULTURAL HERITAGE, VALUES AND HISTORY OF THE TOWN

**SMART-GROWTH PLANNING MODEL
SEFAKO GBOMITA**

MIXED USE DEVELOPMENT: A STRATEGY FOR A COMPLETE AND INTEGRATED COMMUNITY

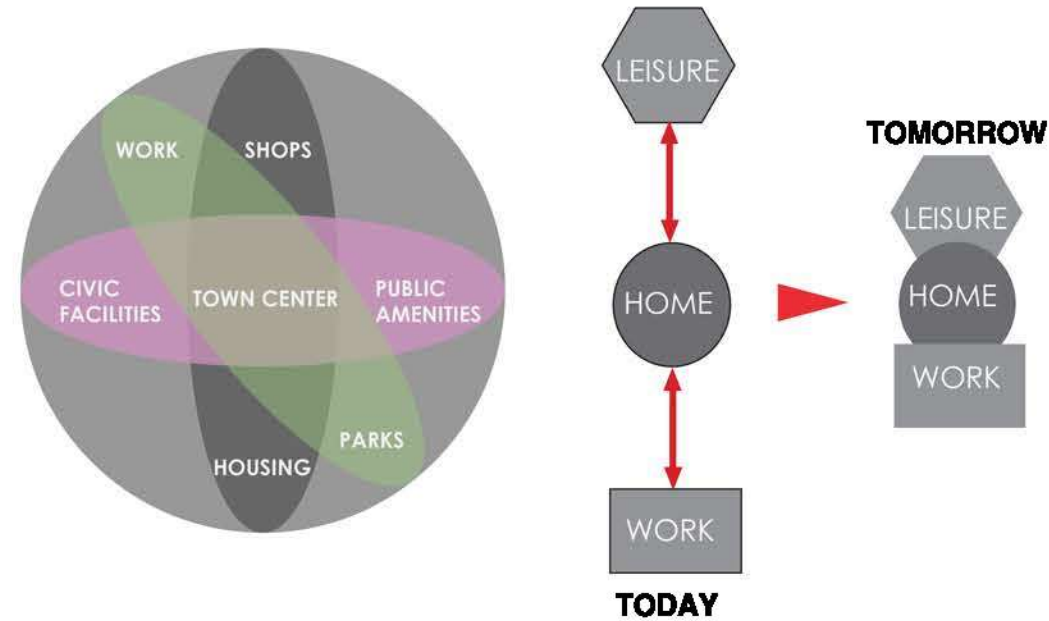

The **Smart-Growth** planning model is envisioned to be a mixed-use development that integrates residential, commercial, institutional and industrial uses. As a response to falling behind more competitive districts in the regional economy, this integrated approach to town planning will revive Suhum's urban space as an asset-a place to generate wealth for the community and for private businesses to thrive.

The principles in the model will re-focus attention back to this once thriving farming community as a cultural hub, an agri-industrial center and a place of knowledge production. This will empower the disadvantaged people to achieve self-sufficiency per **principle one** of the hasselt charter.

PEDESTRIAN ACCESS: A STRATEGY FOR EFFICIENT HIERARCHY OF MOVEMENT

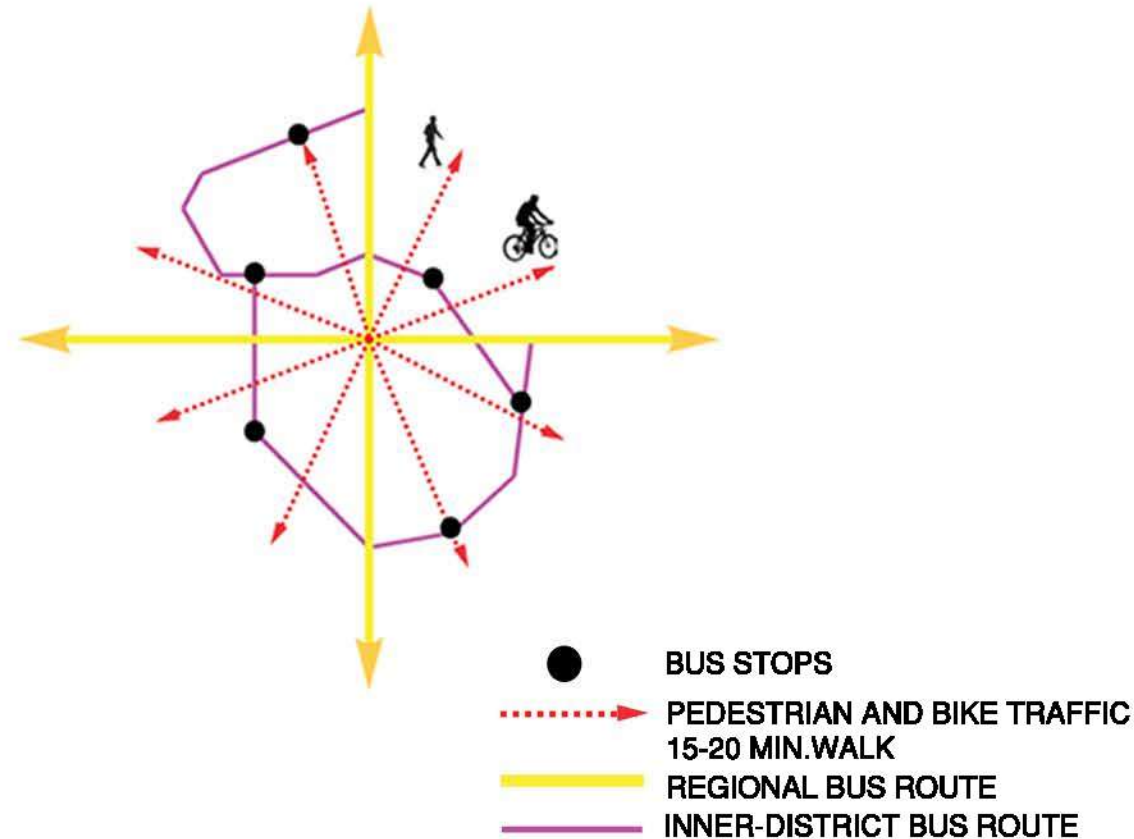

MIXED-INCOME HOUSING: A STRATEGY TO PROMOTE SOCIAL EQUITY BY ENABLING ACCESS TO ADEQUATE AND DIGNIFIED HABITAT IN LINE WITH PRINCIPLE 10 OF THE HASSELT CHARTER



NATURAL LANDSCAPING DRIVES THE DESIGN MODEL AND ENABLES HOMES TO CONNECT THE COMMUNITY TO THE ENVIRONMENT THROUGH INDOOR AND OUTDOOR EXPERIENCES.

COMMUNITY SUPPORTED AGRICULTURE



A SUSTAINABLE FARMING STRATEGY FOR SELF-SUFFICIENT FOOD PRODUCTION

SMART-GROWTH PLANNING MODEL SEFAKO GBOMITA

DEVELOPMENT PLAN: A STRATEGY FOR INCLUSIVE CITIZEN ENGAGEMENT

THE LACK OF EFFECTIVE REGULATORY POLICIES AND PLANNING INITIATIVES BY GOVERNMENT WITHOUT INPUT FROM THE COMMUNITY HAS OVER THE PAST 20 YEARS HAMPERED SUHUM'S PATH TOWARDS ACHIEVING SUSTAINABLE GROWTH. IN MY OPINION, ANY ATTEMPT TO JUMP START THE TOWN'S ENGINES OF ECONOMIC GROWTH TO CREATE SOCIAL EQUITY AND URBAN INCLUSION AS OUTLINED IN PRINCIPLE 4 OF THE HASSELT CHARTER MUST BE COLLABORATIVE. MY DEVELOPMENT PLAN OFFERS A RATIONAL BALANCE OF RESPONSIBILITIES BETWEEN GOVERNMENT, CIVIL SOCIETY AND PRIVATE SECTOR.

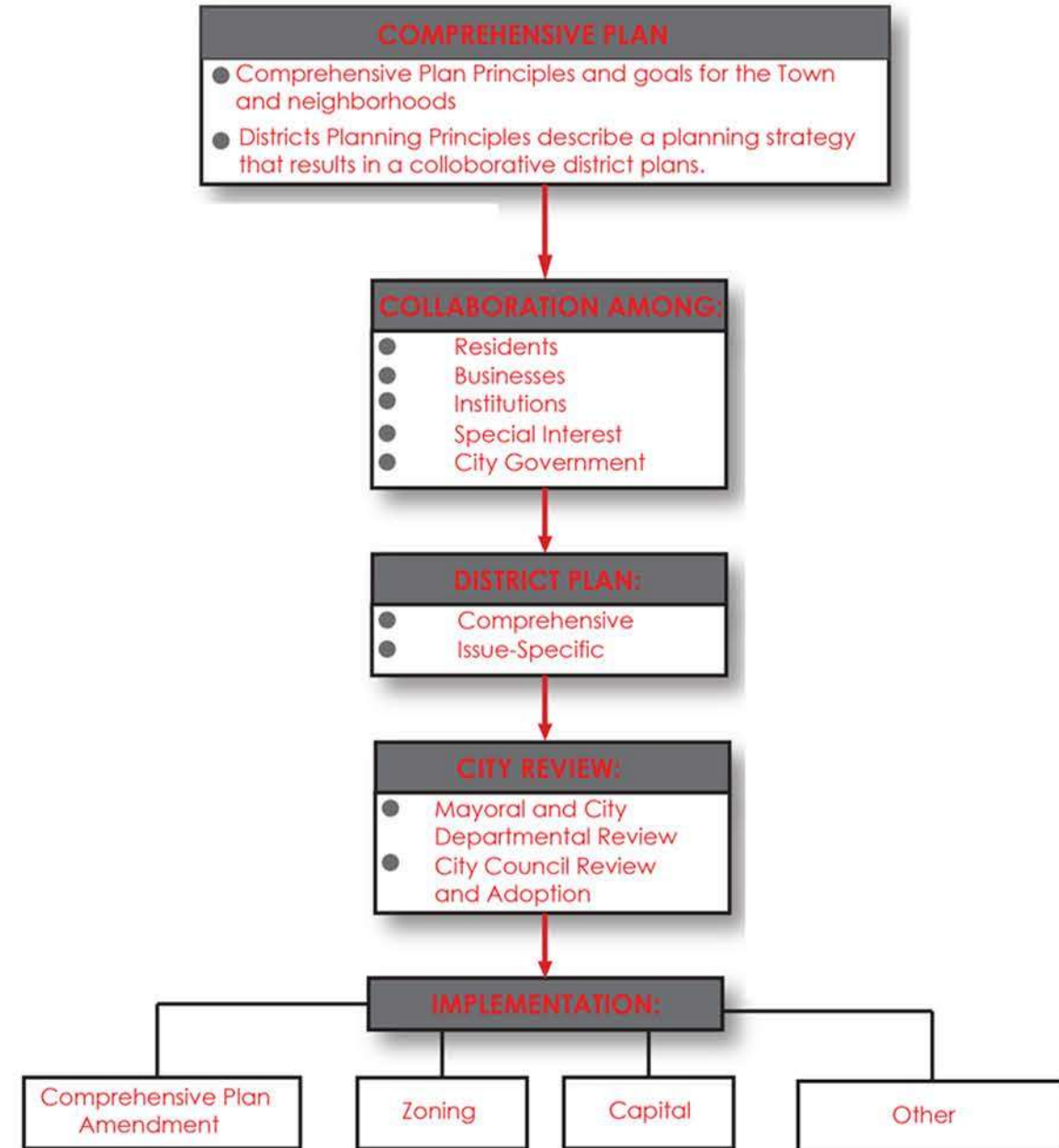



NEW TECHNOLOGY MARKET CENTER: A RESOURCE TO OFFER EDUCATIONAL TOOL KITS AND CONNECT LOCAL BUSINESSES TO THE GLOBAL ECONOMY

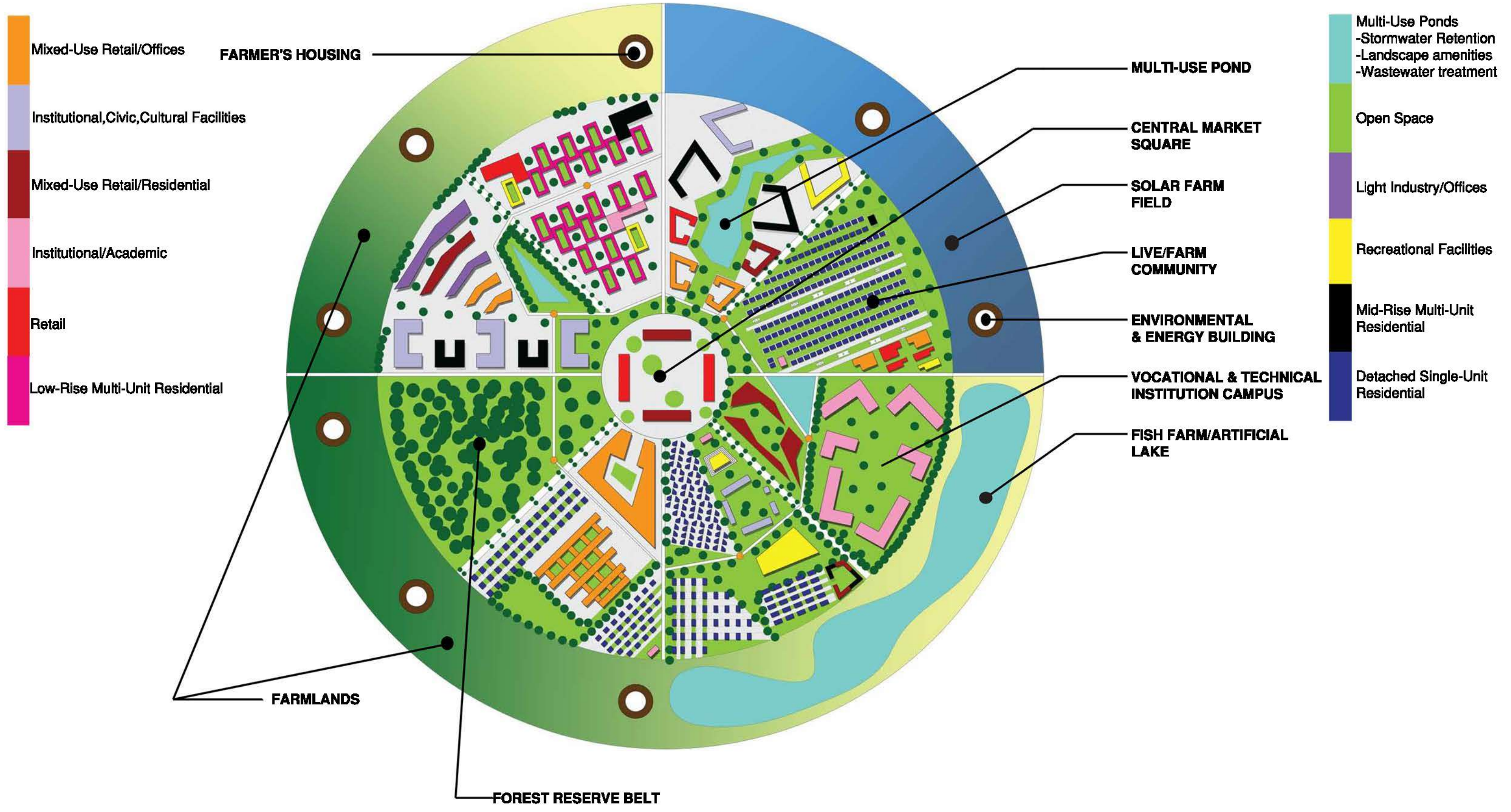

SMART-GROWTH PLANNING MODEL: A STRATEGY FOR A COMPLETE AND INTEGRATED COMMUNITY